

STAGGER WALL PLANK JOINTS ON POSTS. HAVE AS FEW JOINTS PER POST AS POSSIBLE.

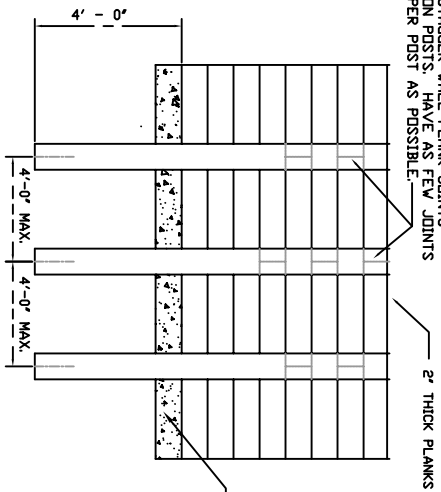

POST & PLANK WALL WALL ELEVATION VIEW

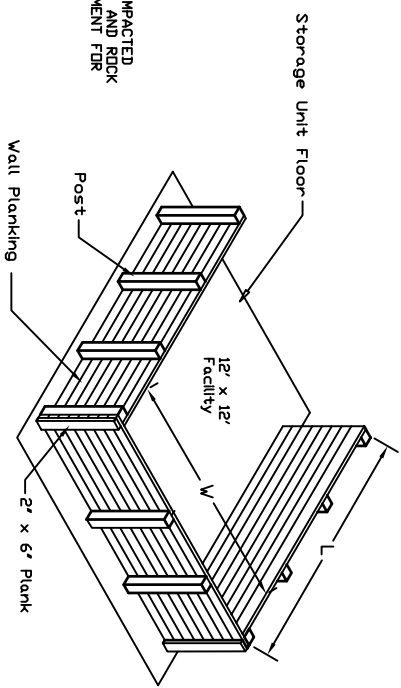
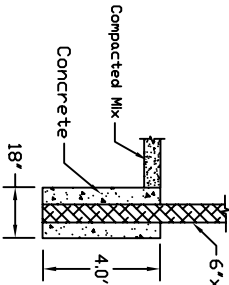

ISOMETRIC VIEW

TYPICAL 2-HORSE STORAGE SIZES

Days Between Emptying	Volume in (Cu. Ft.)	Floor Size in Ft. W x L
90	306	8' x 10'
180	612	12' x 12'
270	918	20' x 12'
365	1230	26' x 12'

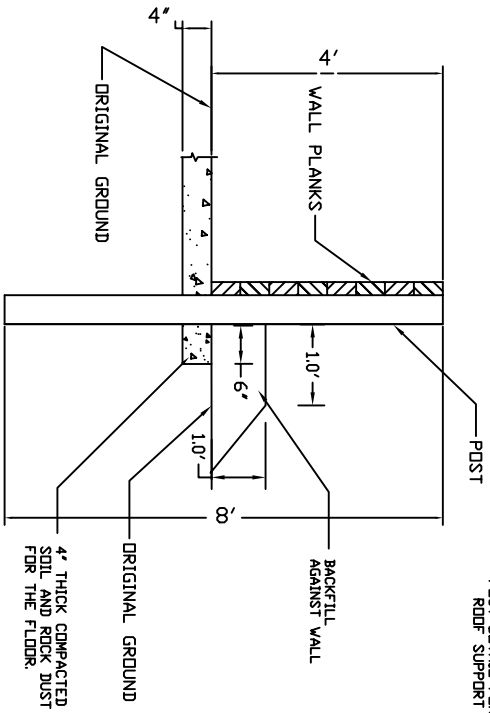

POST DETAIL

(NH\_Post&Plank\_Struct)

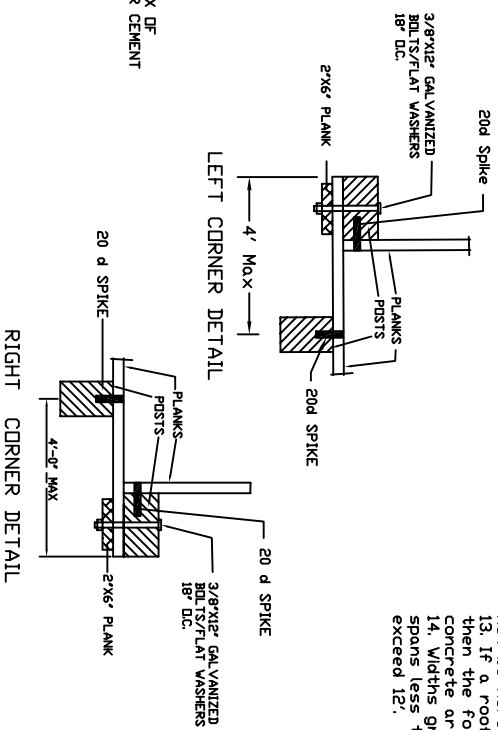

ND SCALE

Material List

Material	CU. FT.	CU. YDS
Stone Dust or Cement Backfill material		
Planks 2"x6" x 8' long	bd. ft.	
Posts 6"x6" x 8' long	ea.	
Bolts/Flat Washers ea	lbs.	
Galvanized 20d Nails	bd. ft.	
Planks 2"x6" x 4' long - corners	CU. YDS	
Concrete (if needed) 4000 psi		

NOTES:

- All posts to be pressure treated with preservative.
- Fasten each plank to each post with at least 2-20d galvanized spikes.
- Post shall be not Hemlock or equal.
- All nails (20d) and bolts and washers shall be galvanized.
- The construction site shall be cleared of all trees, roots, sod, brush, rocks, and debris. All material not suitable for subgrade shall be removed and replaced with compacted earthfill at or above the planned final level.
- The area 10' beyond the floor size will be re-worked with a rototiller after spreading a minimum of 1" of ROKK DUST or PORTLAND CEMENT POWDER over the surface.
- After mixing, the area will be compacted with a weighted yard roller or fabricated tamper and smoothed level. Be sure the original soil surface is damp before beginning the re-work phase.
- Prepare the floor area of the storage facility before laying out and digging post holes.
- Posts shall be placed in post holes, aligned and braced, prior to tamping soil tightly around the posts.
- Joints of wall planking shall be staggered between posts.
- Earth backfill against the outside of the plank wall shall not be more than 12" above the floor level.
- If a roof will be constructed over the Storage Facility, then the four end or corner posts must be installed using concrete around posts - see detail.
- Widths greater than 12' will require mid posts to keep spans less than 12' both front and back. Lengths shall not exceed 12'.

Small Farm Dry Bedded Manure Post and Plank Structure

NAME: \_\_\_\_\_

LOCATION: \_\_\_\_\_

NH DEPARTMENT OF AGRICULTURE  
AG NUTRIENT MANAGEMENT GRANT PROGRAM

DESIGNED BY: Gerald J. Lang, 4/2005  
DRAWN BY: Gerald J. Lang, PE  
CHECKED BY: \_\_\_\_\_  
DATE: \_\_\_\_\_

NO. 11